



BLUE RIBBON CORP.

MODEL 'BR501D' LOW PRESSURE DIAPHRAGM GAUGES

SPECIFICATIONS:

- Available Dial Size: 2 1/2"
- Twist lock plastic lens
- Chrome Plated Case (Bottom Conn.)
- Black Steel Case (Back & PNL Mount)
- Brass Internals and Connection
- Dry, non-fillable
- Accuracy: $\pm 1.5\%$
- Capsule type diaphragm to measure low pressures
- 1/4" (M)NPT bottom or back connection



'LP1'

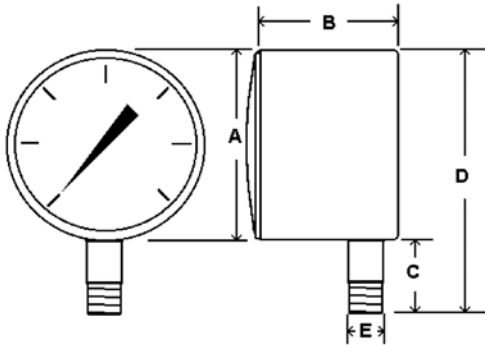

'LP2'

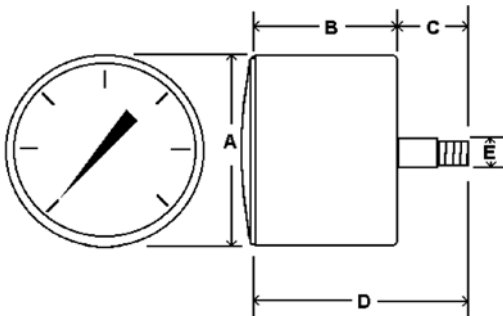

'LP3'

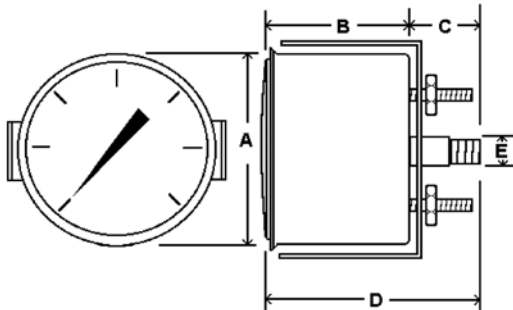

AVAILABLE RANGES:

200-0"WC Vacuum (2" Minor Inc.)
160-0"WC Vacuum (2" Minor Inc.)
100-0"WC Vacuum (1" Minor Inc.)
60-0"WC Vacuum (1" Minor Inc.)
30-0"WC Vacuum (.5"WC Minor Inc.)
0-10"WC (.5"WC Minor Inc.)
0-15"WC (.2"WC Minor Inc.)
0-30"WC (.5"WC Minor Inc.)
20 oz./35"WC (5"WC Minor Inc.)
35 oz./60"WC (1"WC Minor Inc.)
0-60"WC (1"WC Minor Inc.)
0-100"WC (2"WC Minor Inc.)
0-160"WC (5"WC Minor Inc.)
0-200"WC (5"WC Minor Inc.)
0-3PSI (.05PSI Minor Inc.)
0-5PSI (.1PSI Minor Inc.)
0-10PSI (.2PSI Minor Inc.)

	LP1	LP2	LP3
A	2.60"	2.85"	2.85"
B	1.70"	1.60"	1.60"
C	.85"	.85"	.85"
D	3.45"	2.45"	2.45"
E	.55"	.55"	.55"
F	-	2.60"	2.60"

Blue Ribbon reserves the right to make product improvements and amendments to the product specifications stated throughout this brochure without prior notification. Please contact the factory on all critical dimensions and specifications for verification.

A5BR-501D.00 Rev A

2770 Long Road, Grand Island, NY 14072

Tel. (716) 773-9300 • Fax (716) 773-5019 • brsales@blueribboncorp.com • www.blueribboncorp.com